

PLOT 7C - EXISTING NORTH ELEVATION

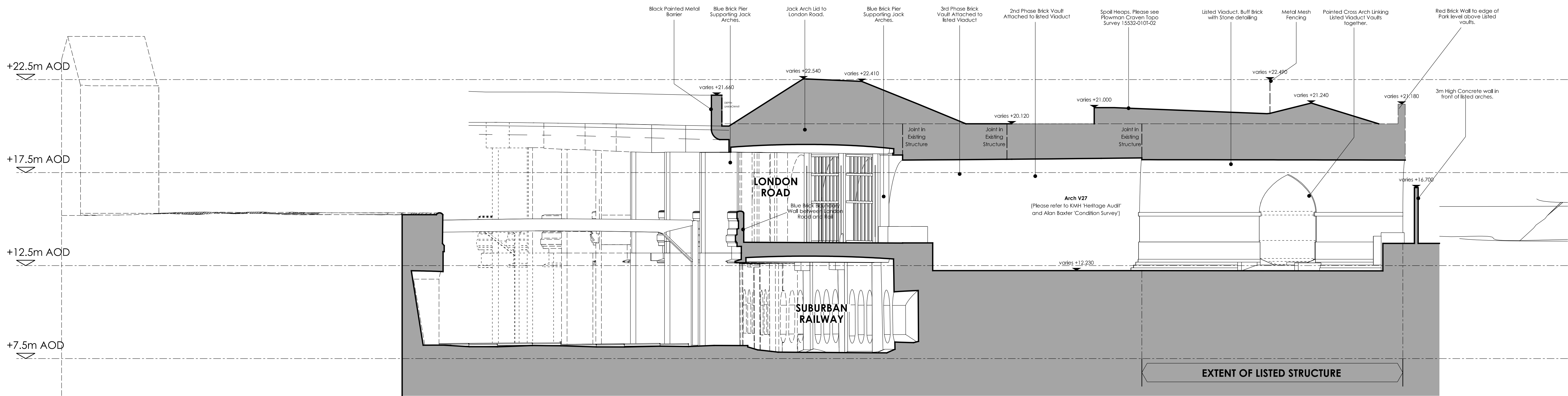

PLOT 7C - EXISTING EAST ELEVATION

**NOTE:**  
**REFER TO PLOWMAN CRAVEN SURVEY DRAWINGS:**

15532-010F-01 (A)	- 3D Street Survey
15532-010F-02 (B)	- 3D Site Topo
15532-010F-03 (A)	- Boundary Drawing
15532-010W-02 (A)	- Railway Cutting
15532-013E-03	- North Elevation of Listed Arches
15532-013E-06	- South Elevation of London Road
15532-013F-01 (B)	- Planimetric Survey
W15532-010SM	- 3D Arch Survey

FOR DETAIL OF ARCHES REFER TO:

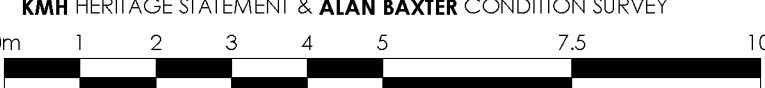

Do not scale this drawing.  
Do not distort dimensions.

[illegible]